

P.U.D. locuinta familiala, anexa si imprejmuire
DEVA, str. Roci, nr. 56C,
beneficiar RAZVAN TENE si FLORI TENE

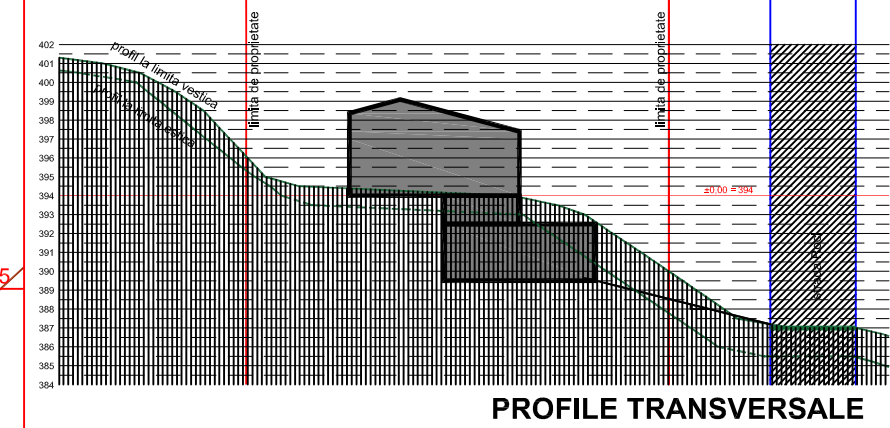

PROFILE TRANSVERSALE

LEGENDA:

- LIMITE CADASTRALE PARCELE
- LIMITA DE PROPRIETATE
- AMPLASAMENT STUDIAT
- DESTINATIA OBIECTIVELOR: CAI DE COMUNICATII AUTO, ZONA DRUMURILOR
- LOCUINTA S+P, Hmax = 6,70 m
- ANEXA P, Hmax = 4,00 m
- ALEI CAROSABILE IN INCINTA
- ALEI PIETONALE IN INCINTA
- ZONE VERZI AMENAJATE
- PLATFORMA GOSPODAREASCA

INDICI URBANISTICI:

S teren = 494 mp
Sc = 110,00 mp
Sd = 165,00 mp
POT = 22,27 CUT = 0,33
POT max (HG 525/1996) = 35%

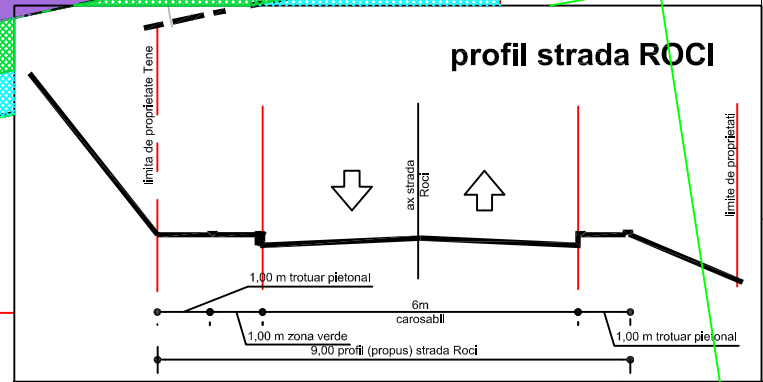

verificator		Referat de verificare nr.	
SC ABSOLUT DESIGN srl DEVA		den. pr.	proiect nr. :
		LOCUINTA FAMILIALA, ANEXA SI IMPREJMUIRE Deva, strada Roci, nr. 56C, jud. Hunedoara	
Sef proiect	arh. Dan Mihaila	scara:	beneficiar:
Proiectat	arh. Dan Mihaila	1: 200	TENE RAZVAN NOROCEL, TENE FLORI SIMONA
Desenat	arh. Dan Mihaila		denumirea plansei:
			PLAN DE SITUATIE REGLEMENTARI URBANISTICE
			plansa nr. A 3

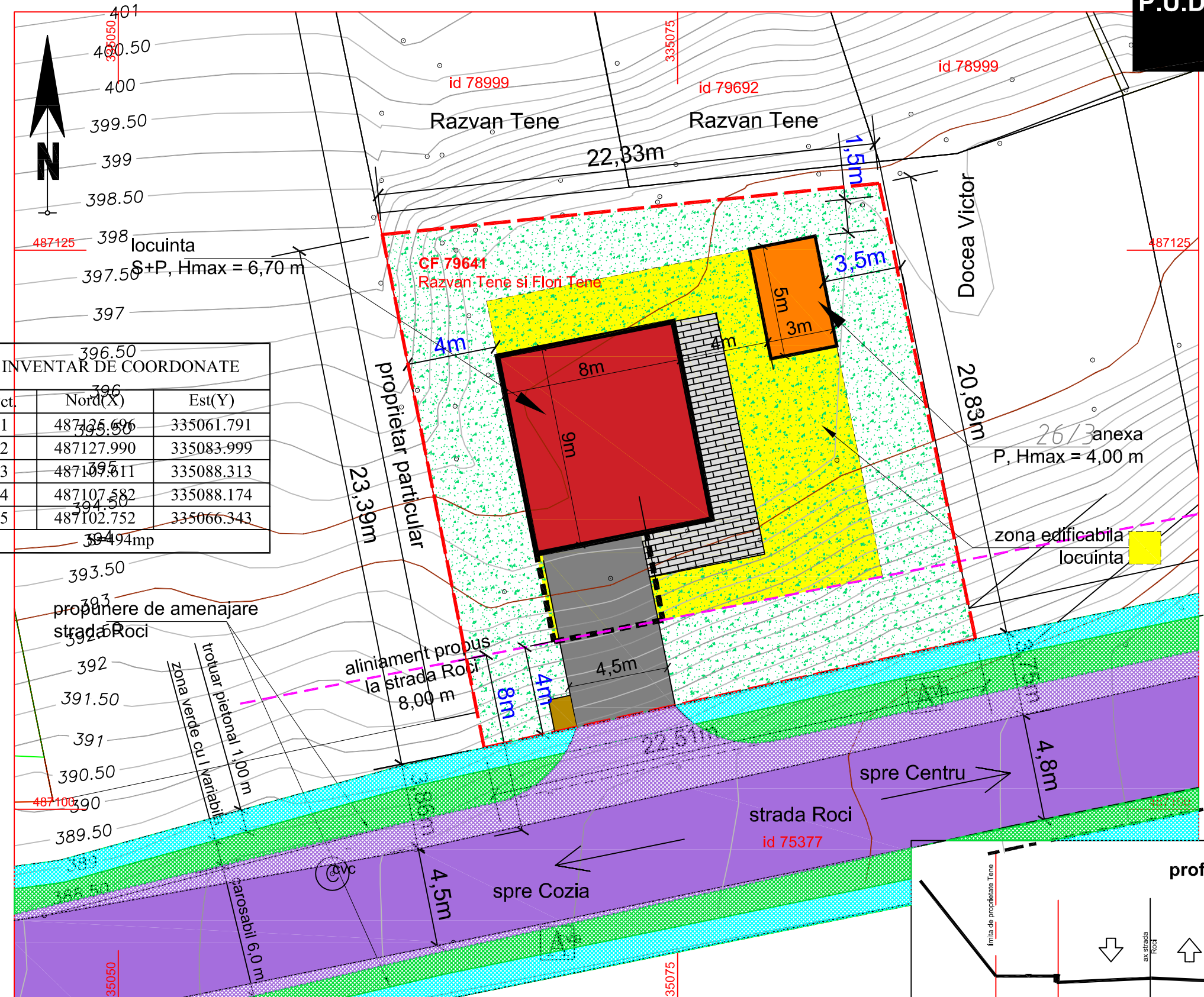

INVENTAR DE COORDONATE

Pct.	Nord(X)	Est(Y)
1	487125.996	335061.791
2	487127.990	335083.999
3	487109.811	335088.313
4	487107.582	335088.174
5	487102.752	335066.343

ZONE FUNCTIONALE	EXISTENT		PROPOS	
	Suprafata (mp)	Procent din total intravilan (%)	Suprafata (mp)	Procent din total intravilan (%)
TEREN INTRAVILAN	494	100	494	100
DIN CARE:				
TEREN PASUNE	494	100	-	-
CAI DE COMUNICATIE	-	-	35	7.1
-drumuri, platforme, accese	-	-	-	-
SPATII VERZI, PROTECTIE	-	-	345	69.8
CONSTRUCTII TEHNICO-EDILITARE	-	-	2	0.4
PLATFORMA GOSPODAREASCA	-	-	2	0.4
CONSTRUCTII LOCUINTE SI ANEXE	-	-	110	22.3
TOTAL INTRAVILAN	494 mp		494 mp	